

No. 1

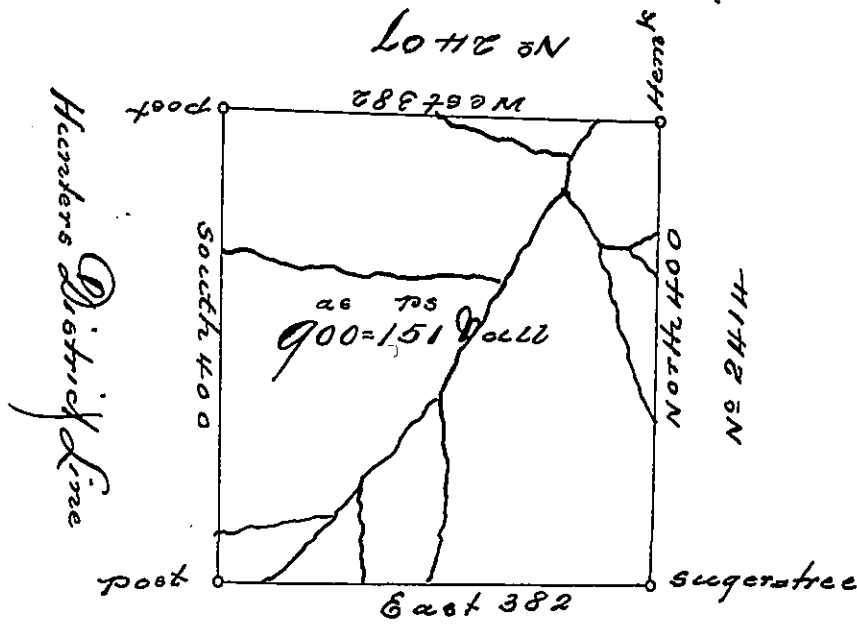

Situate about four miles West of Canonsdaal Creek and twenty miles South of the State Line in Northumberland County, Containing 900 acres 151 perches and the usual allowance for Roads &c. Surveyed July 17th 1793 for Wilhem Willink, Nicolaus Van Staphorst, Christian Van Eighen, Hendrick Vollenhoven, and Rutger Jan Schemmelpenninck, in pursuance of a warrant No 2406 bearing date the 12th day of December, 1792.

Daniel Broadhead Esquire
J.G.

John Canan, J.

IN TESTIMONY that the above is a copy of the original remaining on file in the Department of Internal Affairs of Pennsylvania, made conformably to an Act of Assembly approved the 16th day of February, 1833, I have hereunto set my Hand and caused the Seal of said Department to be affixed at Harrisburg, this first day of August, 1899.

Jamez Latta
Secretary of Internal Affairs.